

S/D.O.

E-IN-C 438
GEN. GEN. 0002

TRIM TO THESE LINES 13" x 8"

DRG DPL/697

POST OFFICE ENGINEERING DEPT S BRANCH	
P.O.	DISTRIBUTION GENERAL
REFERENCES	
SPEC. BS. 771 S 116	SPEC. D1000
ASSEMBLY DRG.	WIRING DISM.
FILE S 3200/DPL/	SPEC.
SCALE :- 1 AND AS THIRD ANGLE PROJECTION	
DECIMAL DIMENSIONS NOT TOLERANCED	
SUBJECT TO	
APP'D IN S 2 SECTION R.H. CHAPMAN. A.M.H.	DRN S.J.L. TGD. H.M.M. CND H.C.C. DATE 15-10-54
AMENDMENT	SUFFIX
SEE SUPERSEDED ISSUE FOR PREVIOUS AMENDMENTS.	
REDRAWN. THREADED HOLE :- CORE DIA. WAS 0.529" MAX. P.M.L. <i>[Signature]</i> 15.12.61	
FOR SUPERSEDED	
PARTS 1&2/DPL/697 (PLATE, JACK)	
DRG DPL/697	

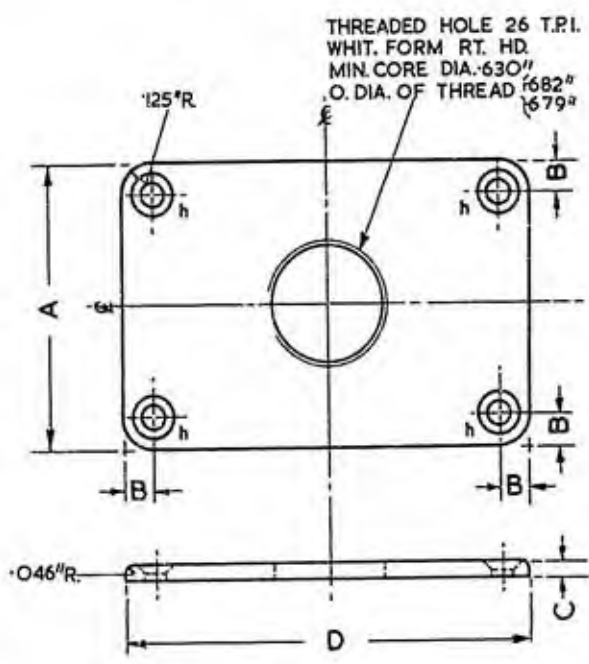

MATERIAL :- SYNTHETIC RESIN (PHENOLIC) MOULDING MATERIAL
TYPE MS, BLACK, SPECS. B.S. 771 & 5116.

FINISH :- FRONT FACE & EDGES POLISHED FROM MOULD.

DO NOT SCALE
(A MICROFILM PROCESS PRINT)

PART	DIMENSIONS (INS.)				HOLES 'h'
	A	B	C	D	
1/DPL/697	1.812	.218	.128	2.687	.154" D. CSK. FOR No. 6 WD. SC.
2/DPL/697	2.750	.250	.128	2.625	.154" D. CSK. FOR No. 6 WD. SC.

LIMIT OF DRAWING SPACE

MASTER