

DRG. 66238

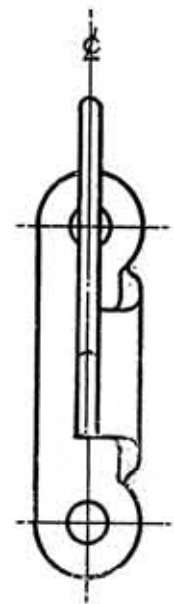
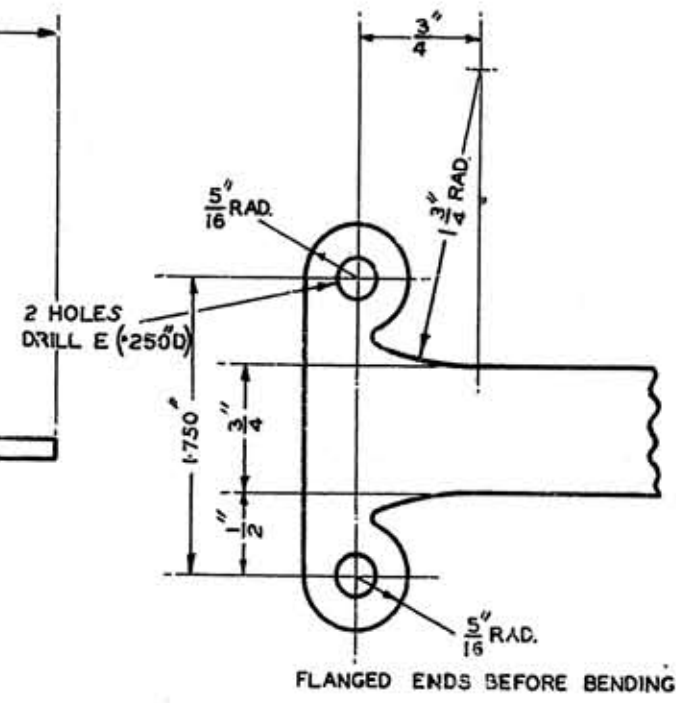
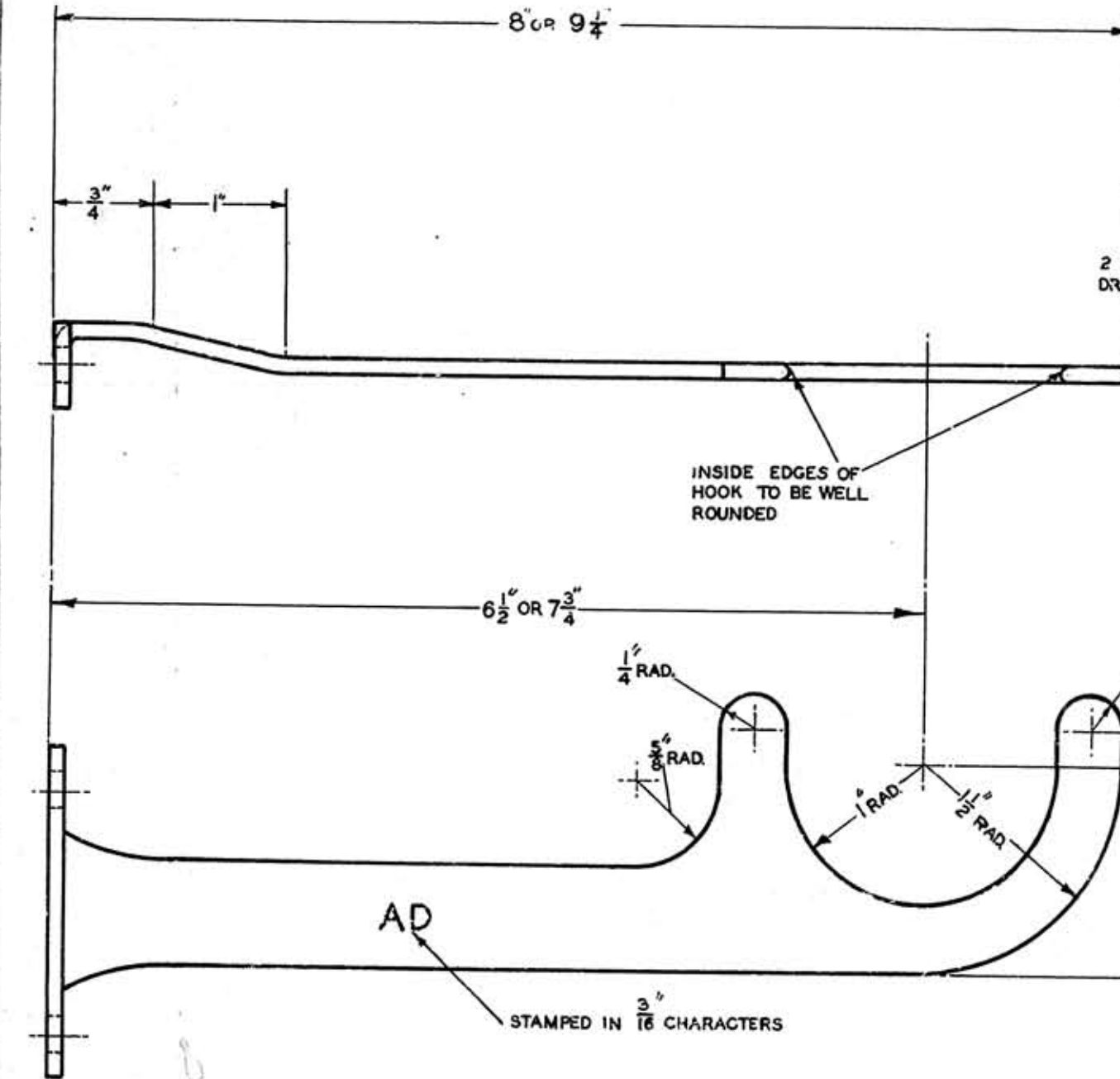

AD
STAMPED IN $\frac{3}{16}$ CHARACTERS

MATERIAL: M.S. C.R.C.A. $\frac{1}{8}$ "
FINISH: N.L.P. MT.

TRIM TO THESE LINES 13" x 16"

POST OFFICE ENGINEERING DEPT.
E-IN-C'S OFFICE L BRANCH

DISTRIBUTION
P.O. TELEPHONE TRANSMISSION EQUIPT.

REFERENCES
SPEC D1000

ASSEMBLY DRG
WIRING DGM

FILE 582/18
SPEC. —

SCALE: $\frac{1}{1}$ AND AS INDICATED
3RD ANGLE PROJECTION

DECIMAL DIMENSIONS NOT TOLERANCED
SUBJECT TO $\pm .005$ "; FRACTIONAL $\pm \frac{1}{64}$ "

APP'D. IN LIA SECTION
DRN. *AK*
TCD. *BS*
CHKD. *JK*
DATE 17-10-47

AMENDMENT SUFFIX

SUPERSESION NOTE ADDED.
AK JK 2-2-48 A

TITLE WAS: HOOK, RECEIVER AD
DIM. $6\frac{1}{2}$ OR $7\frac{3}{4}$ WAS $6\frac{1}{2}$ "
DIM 8 OR $9\frac{1}{4}$ NOW ADDED.
JK 20.150 B

SUPERSEDES
DRG. 66,143

HOOK, RECEIVER
AD 8", OR AD $9\frac{1}{4}$ "

DRG. 66238

E-IN-C.147
GEN. GEN. D0032

S/D.O.